

**THE COUNCIL OF THE BOROUGH OF STOCKTON-ON-TEES**

**IDA STREET, STOCKTON-ON-TEES GATING ORDER No.3 2006**

**HIGHWAYS ACT 1980 (incorporating The Clean Neighbourhoods and Environment Act 2005 Section 2)**

This Order is made by The Council of the Borough of Stockton-on-Tees ("the Council") under Section 129A of the Highways Act 1980 ("the 1980 Act") because the Council is satisfied that premises adjoining or adjacent to the highway are affected by crime or anti-social behaviour, the existence of the highway is facilitating that crime or anti-social behaviour and that it is expedient to make the Order for the purposes of reducing that crime or anti-social behaviour.

**BY THIS ORDER**

1. Access to the public right of way beyond the barriers located on the highway described in Schedule 1 below shall be restricted daily from 8 p.m. during autumn, winter and spring until 5 a.m. and from 10 p.m. during summer as defined by British Summer Time until 5 a.m. commencing on the date of the making of this Order
2. The restriction will continue for a minimum of 2 years and the continued need for the restricted access will be reviewed by the Council on an annual basis
3. The barriers may be locked earlier by a uniformed Council Officer following any reports of serious anti-social behaviour
4. Alternative routes are described in Schedule 2 below
5. Those persons and groups described in Schedule 3 below shall be exempt from the provisions of this Order
6. The installation, operation and maintenance of the barriers at the end of the highway for the enforcement of the restriction is hereby authorised

**SCHEDULE 1**

At the western end of Ida Street at a point level with the frontage of the properties known as 22 and 25 Ida Street as shown by a red line on Order Plan 1.

**SCHEDULE 2**

Alternative access can be gained via Norton Road and Waterford Road by following the route shown on Order Plan 2 by a purple line for approximately 1199 metres.

Alternative access can be gained via Derwent Street by following the route shown by a blue line on Order Plan 2 for approximately 611 metres.

Alternative access can be gained via Bolsover Road by following the route shown by a red line on Order Plan 2 for approximately 515 metres.

Any person for whom the alternative routes are unsuitable may arrange for access through the barriers by telephoning 01642 618946.

**SCHEDULE 3**

Emergency Services, Statutory Undertakers, persons acting in their capacity as Officers of the Council, persons and/or vehicles required, where necessary, in connection with maintenance work.

The barriers to be erected to give effect to this Order shall be maintained by the Council. If you should need to contact the Council regarding the condition of the barriers please contact the Council's Care for your Area Team on 01642 528382.

**Dated this 27<sup>th</sup> day of July 2006**

Executed as a deed by affixing  
the Common Seal of The Council of the Borough of Stockton-on-Tees  
in the presence of:

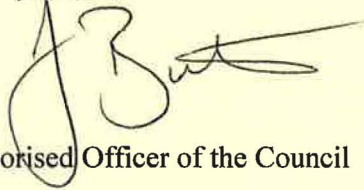

Authorised Officer of the Council



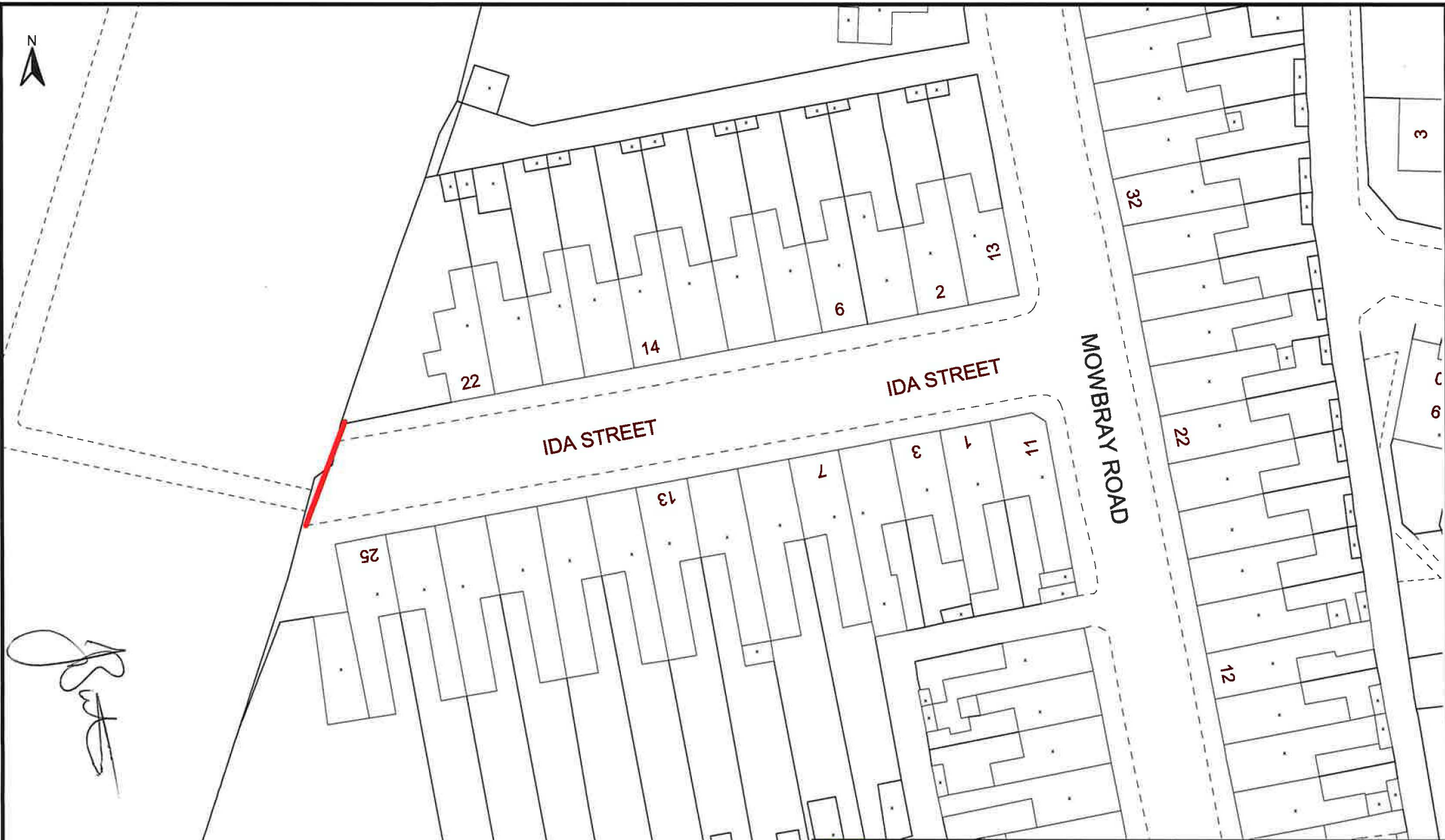

**KEY**

 Location of pedestrian gates/fencing.

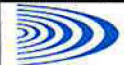

**Stockton-on-Tees**

BOROUGH COUNCIL

Development & Neighbourhood Services  
 Head of Eng. & Trans.: M. P. Robinson, B.Sc., C.Eng., M.I.C.E., F.I.H.T.  
 P.O. Box 229, Kingsway House, West Precinct, Billingham. TS23 2YL  
 Telephone: (01642) 393939

Date: 19/04/2006

This map is reproduced from Ordnance Survey material with the permission of Ordnance Survey on behalf of the Controller of Her Majesty's Stationery Office. © Crown copyright. Unauthorised reproduction infringes Crown copyright and may lead to prosecution or civil proceedings. Stockton-on-Tees Borough Council 100023297 2005

Title Location of alleygates.  
 Ida Street, Norton.

*ORDER Plan 1*

Scale 1:500

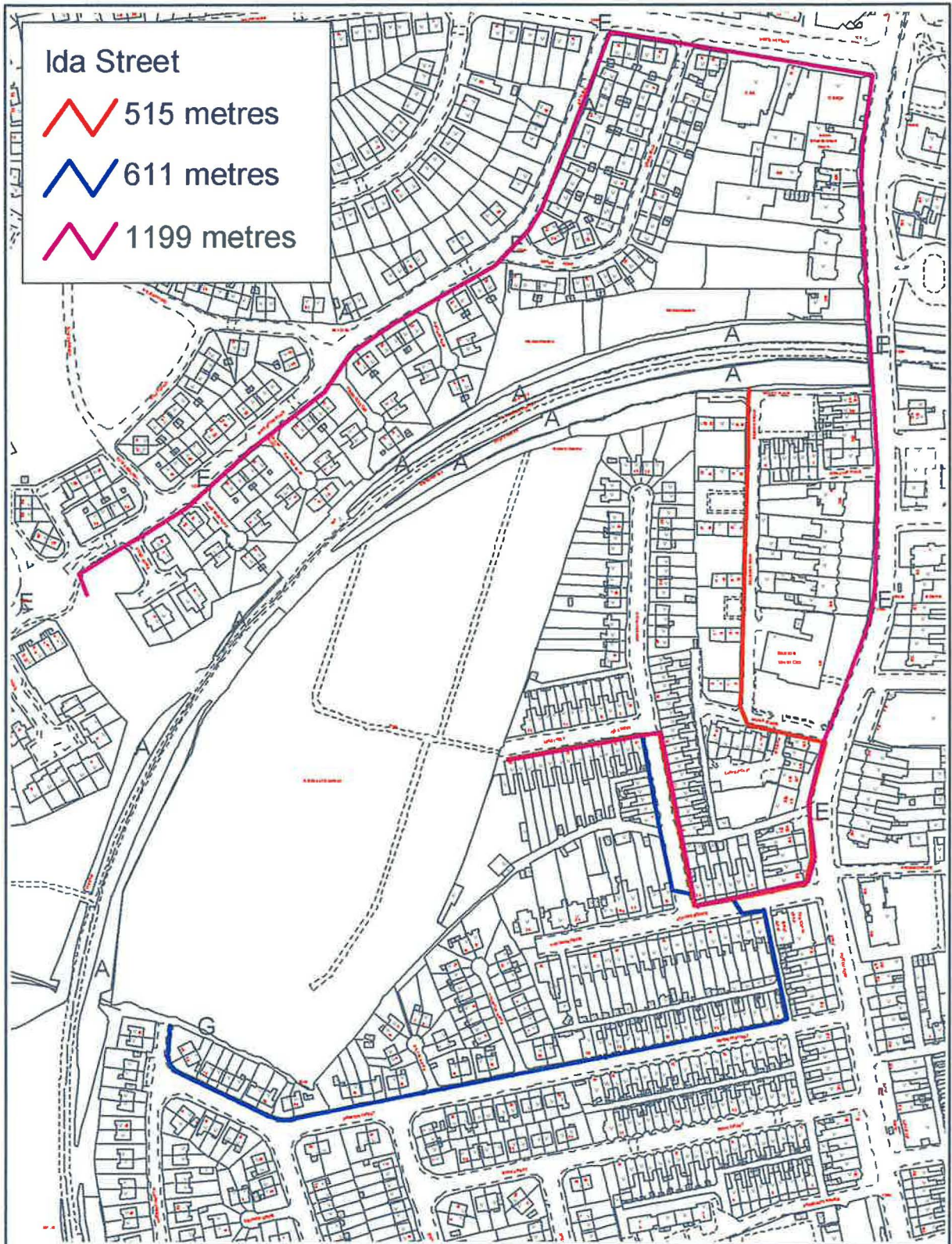

**Development & Neighbourhood Services**  
 Corporate Director: N Schneider  
 Head of Planning & Environment: S Barker  
 P.O. Box 34, Gloucester House, Church Road, Stockton-on-Tees, TS18 1TW  
 Telephone: (01642) 393939

This map is reproduced from Ordnance Survey material with the permission of Ordnance Survey on behalf of the Controller of Her Majesty's Stationery Office. © Crown copyright. Unauthorised reproduction infringes Crown copyright and may lead to prosecution or civil proceedings. Stockton-on-Tees Borough Council 100023297 2005

Title Stockton Borough	Drawing No.	Date	Scale 1:2500
------------------------	-------------	------	--------------

ORDER PLAN 2