

# BILLINGHAM TOWN CENTRE MASTERPLAN

# Current Town Centre

Dawson House

West Precinct

Queensway South

John Whitehead Park

Billingham Library

Aldi

Billingham Forum

Town Square



# Area for Redevelopment

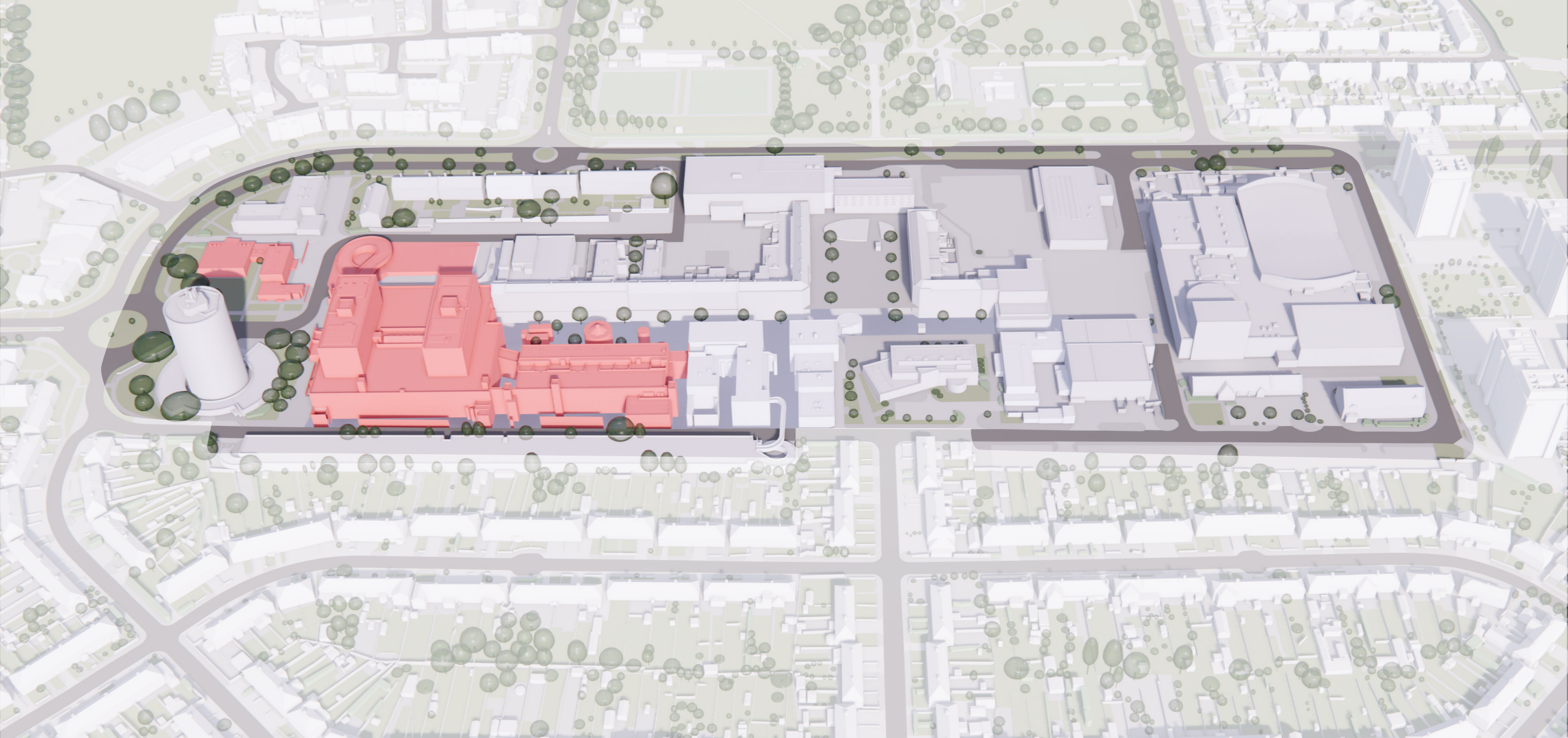



# Proposal

- Circa 160 New Residential Units
- Circa 2,300sqm New Commercial Space
- Infrastructure Enhancements
- Improved Public Spaces



Aerial View looking West



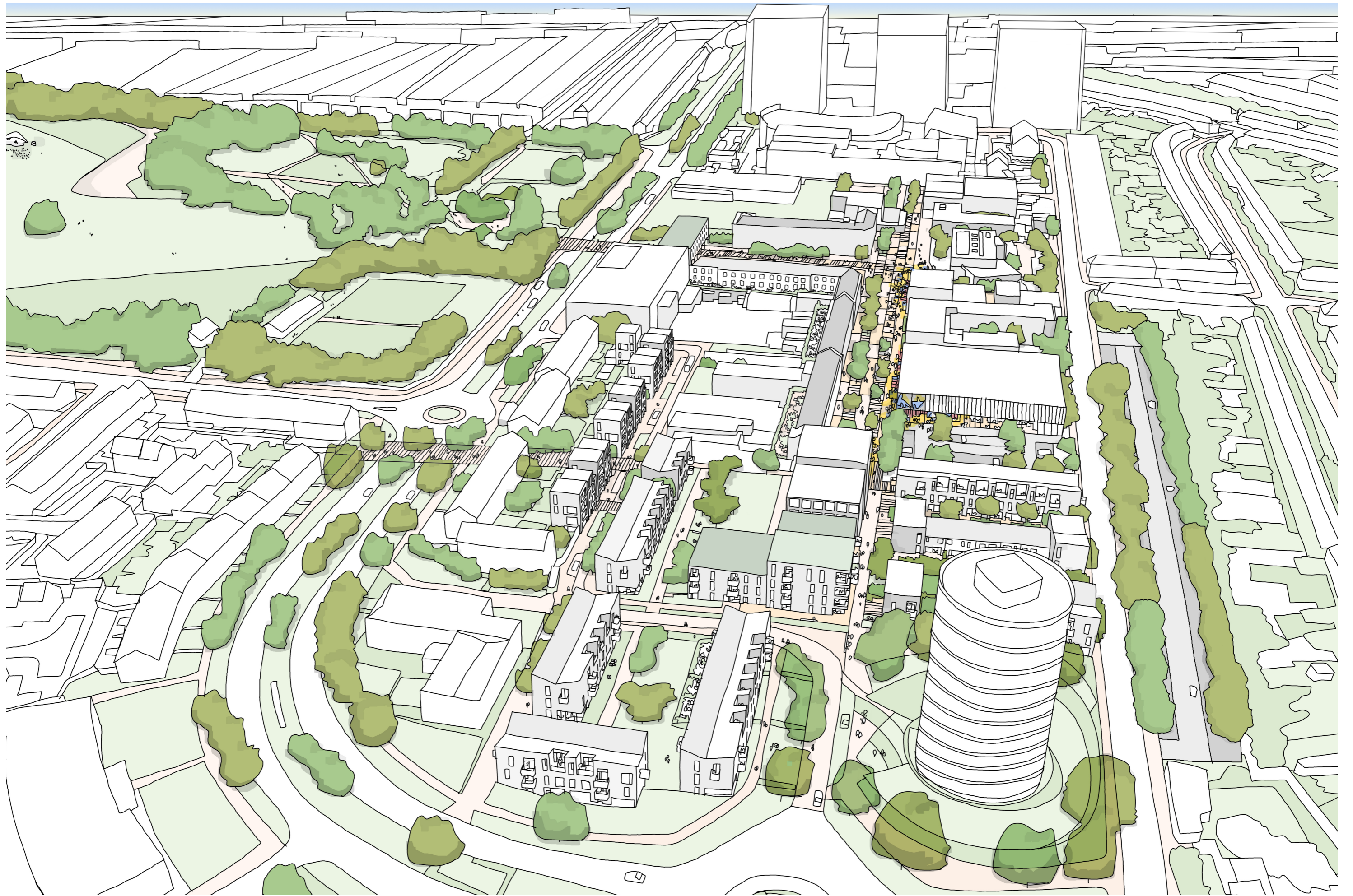





London Studio  
The Leather Market  
Weston Street  
London SE1 3ER  
020 7253 7644

Manchester Studio  
4<sup>TH</sup> Floor, The Hive  
47 Lever Street  
Manchester M1 1FN  
0161 228 0211

[5plusarchitects.com](http://5plusarchitects.com)

**GOING  
BEYOND  
THE  
EXPECTED**